

## ABS3 Fire Damper Actuator



### Features

- 70°C (or 280°C) automatic close-off
- Manual close-off
- Manual opening (with 6 position)
- 2 Output signal at close-off

### Application

Fire Damper

### Technical Data

Torque	10 Nm
Angle Deflection	0-90°
Switch Contact	250VAC , 5A; 24VDC, 5A
Operating Temperature of Heat Sensor	70°C (or 280°C)
Protection	IP21
Ambient	-10 ~ 50°C, RH 85%
Weight	1 kg

### Wiring Diagram

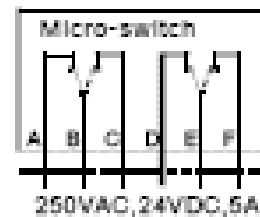

### Dimension

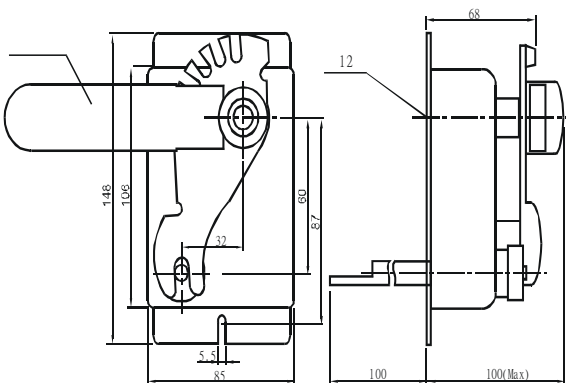

### Installation

1. This device is equipped with spring action. Additional spring on the damper is needed if The operating torque is greater than the actuator.
2. To suit damper shaft direction, this device provide LEFT and Right type for selection. Allow 200mm clearance space.
3. For easy transport, handle, sensor, and mounting bracket are packed separately. Assemble before installing onto the damper.
4. Select suitable damper shaft to match. Test manually, make sure the damper moves properly after fixing the actuator onto the damper.
5. Electrical wiring should be handled by professionals. Check the supply voltage and isolate the power before wiring.
6. Use the device in accordance with local fire regulation. Regular inspection and testing are needed.

### Order

When placing order, please specify product name, model number, operating direction, sensor temperature and other requirements.

For example: Fire Damper Actuator, ABS3, Left type, 70°C, 100pcs.